

CDM

CDM-ISO-T



CDM-ISO-T Resilient Sound Insulation Battens are designed to optimise the sound insulation of walls. The battens are direct fixed to the existing wall without the need for independent framework. Plasterboard or other wall boards can then be fixed to the battens.

Two standard types are available
 CDM-ISO-T-56, creates 56mm void
 CDM-ISO-T-96, creates 96mm void

Other void depths available on request

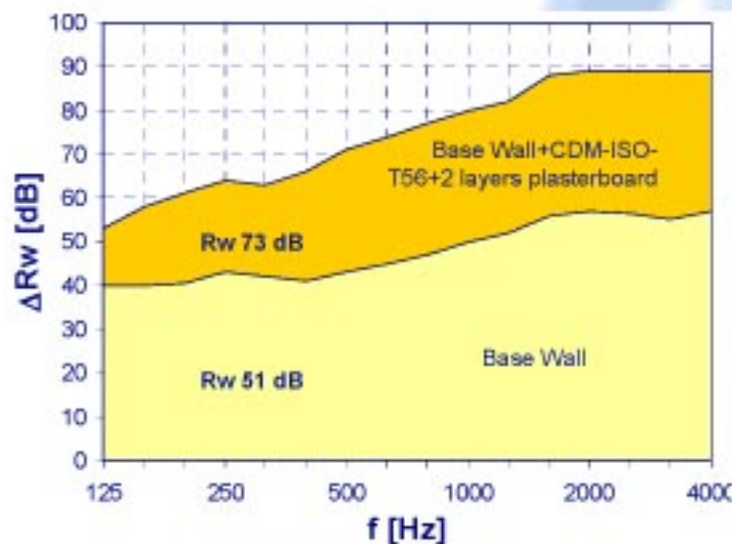

Advantages

- 1 optimises sound insulation for a given additional wall
- 2 can be used for most additional dry wall constructions
- 3 can be used for several applications
- 4 easy to install

Example: 190mm brick wall; improvement 22dB

Installation guidelines:

1. Install perimeter and base isolation strips (CDM-ISO-PERIMETERSTRIP);
2. Fix CDM-ISO-T batten to the wall at approximately 600mm centres to match the joints of the first layer of plasterboard or wall board;
3. Install low density mineral fibre between battens;
4. Fix first layer of plasterboard or wall board to CDM-ISO-T battens ensuring that it butts tightly to the perimeter and base isolation strips;
5. Fix damping sheet and then additional layers of plasterboard (fixings must not touch supporting wall);
6. Skim plaster and paint to finish.

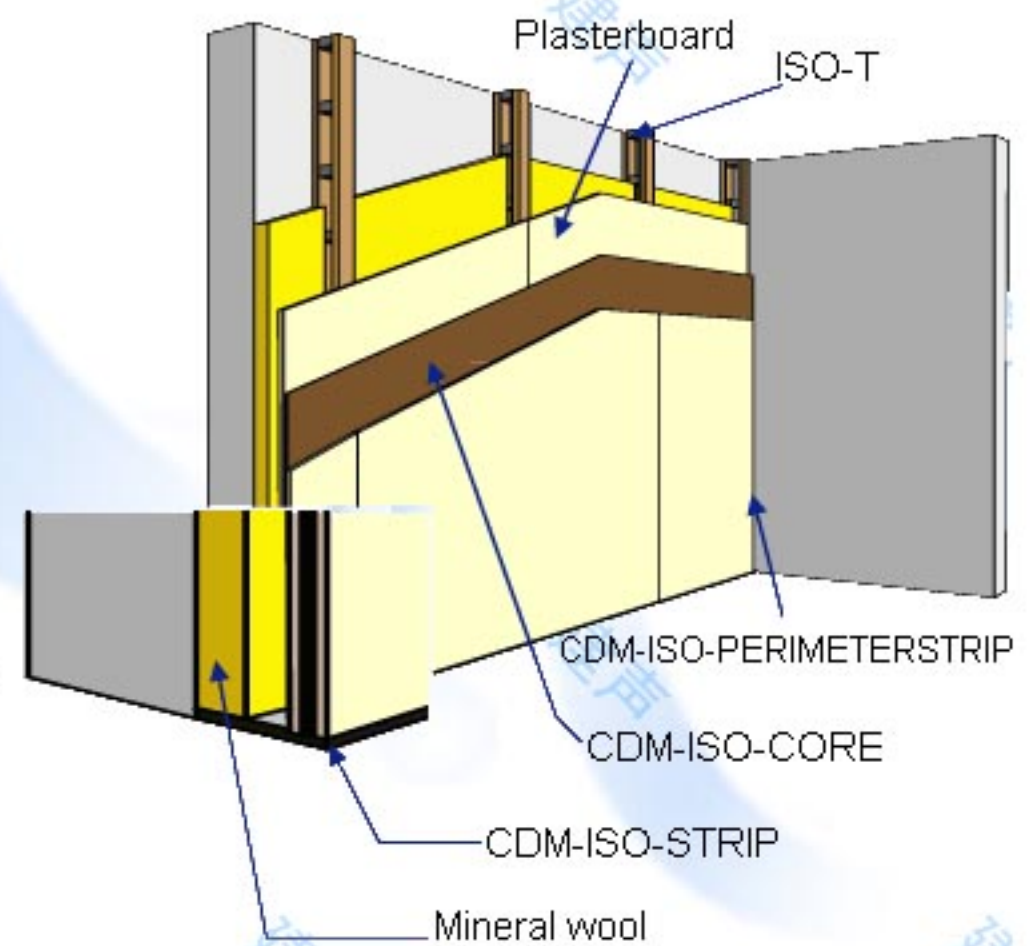

Installation of the CDM-ISO-T battens